

Readings for each coil independent of all others on air core (No Ferrite)

	Unit	Feedback	Primary	Secondary	L1	L2
Gage		29	29	29	29	29
Thickness	inches	0.0155	0.0155	0.0155	0.0155	0.0155
Resistance	Ohms	11.5	10.5	72.4	76.7	70.1
R @ 100Hz	Ohms	12	10.48	100.2	106.5	93.27
R @ 120Hz	Ohms	12.14	10.53	110.4	119.7	103.5
R @ 1kHz	Ohms	49.35	21	2.64k	3.15k	2.46k
R @ 10kHz	Ohms	3.22k	946	190.6k	1200k	1200k
L @ 100Hz	H	3.47mH	1.65mH	68.7mH	76.32mH	64.32mH
L @ 120Hz	H	3.3mH	1.65mH	68.6mH	76.28mH	64.3mH
L @ 1kHz	H	3.3mH	1651uH	68.6mH	76.28mH	64.26mH
L @ 10kHz	H	3.3mH	1651uH	69.4mH	77.36mH	65mH
C @ 100Hz	F	23.7uF	14.8uF	9.73uF	9.38uF	9.89uF
C @ 120Hz	F	23.3uF	15uF	8.72uF	8.33uF	8.91uF
C @ 1kHz	F	5.75uF	7.6uF	351.5nF	317.1nF	374.6nF
C @ 10kHz	F	83nF	164.5nF	3.95nF	3.55nF	4.22nF

Readings for each independent from all others with Ferrite core

	Unit	Feedback	Primary	Secondary	L1	L2
R @ 100Hz	Ohms	31	74.9	5.48k	7.36k	6.47k
R @ 120Hz	Ohms	39.4	102.5	7.78k	10.35k	9.13k
R @ 1kHz	Ohms	1797	6.3k	850k	1270k	1100k
R @ 10kHz	Ohms	103k	N/A	N/A	N/A	N/A
L @ 100Hz	H	23.9mH	41.8mH	1047.2mH	1262.7mH	1138mH
L @ 120Hz	H	23.88mH	41.7mH	1043.7mH	1257mH	1132.3mH
L @ 1kHz	H	23.66mH	40.88mH	1012.5mH	1218.8mH	1093mH
L @ 10kHz	H	28.59mH	48.5mH	N/A	N/A	N/A
C @ 100Hz	F	65.9uF	52uF	2.42uF	2.01uF	2.24uF
C @ 120Hz	F	51.7uF	37.75uF	1.69uF	1434.9nF	1599.6nF
C @ 1kHz	F	1053.4nF	614.3nF	24.59nF	20.42nF	22.78nF
C @ 10kHz	F	9.66nF	5.69nF	206.7pF	157.7pF	180pF

Readings for coils connected in series on Ferrite core.

	Unit	Feedback	Primary	Secondary	L1 & L2
R @ 100Hz	Ohms	14.99	Same	3.4k	1446
R @ 120Hz	Ohms	16.05	As	4.81k	2.03k
R @ 1kHz	Ohms	254.8	Above	400k	137k
R @ 10kHz	Ohms	18.95k	Readings	162.2k	N/A
L @ 100Hz	H	8.894mH		855mH	608.6mH
L @ 120Hz	H	8.85mH		852mH	607.2mH
L @ 1kHz	H	8.71mH		837.7mH	600.6mH
L @ 10kHz	H	8.73mH		805.2mH	662.3mH
C @ 100Hz	F	46.9uF		2.91uF	3.86uF
C @ 120Hz	F	43.65uF		2.04uF	2.75uF
C @ 1kHz	F	2.7uF		29.7nF	41.3nF
C @ 10kHz	F	31.44nF		318.5pF	415.5pF

Delrin encased tubes with various water types

	Unit	Empty	Tap Water	Distilled Water	Rain Water	Series (10 tubes)
R @ 100Hz	Ohms					
R @ 120Hz	Ohms					
R @ 1kHz	Ohms					
R @ 10kHz	Ohms					
L @ 100Hz	H					
L @ 120Hz	H					
L @ 1kHz	H					
L @ 10kHz	H					
C @ 100Hz	F	22pF	24.85uF	670nF	655nF	2.52uF
C @ 120Hz	F	21pF	23uF	600nF	505nF	2.29uF
C @ 1kHz	F	21.6pF	5.72uF	25nF	21nF	446.6nF
C @ 10kHz	F	21.58pF	288.5nF	N/A	N/A	N/A

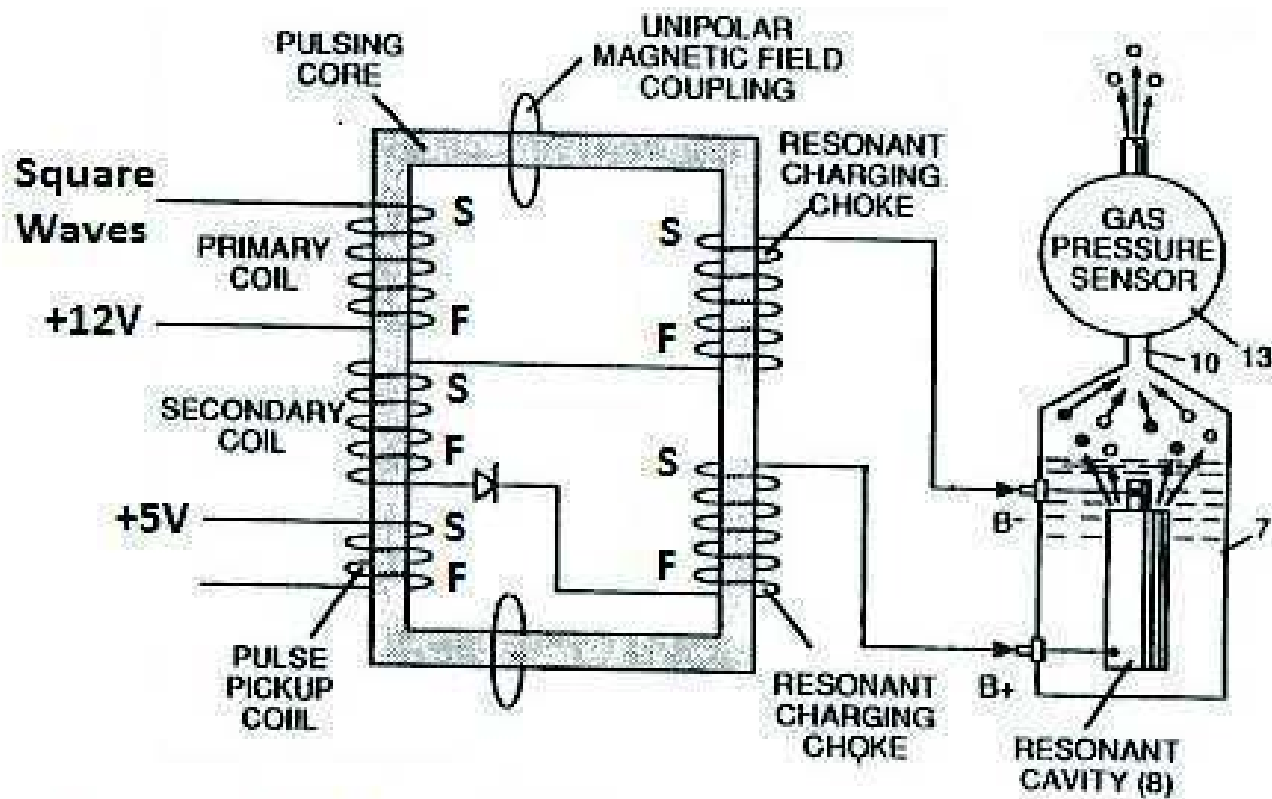

S = Start of wire
F = End of wire
Diode = MUR1550

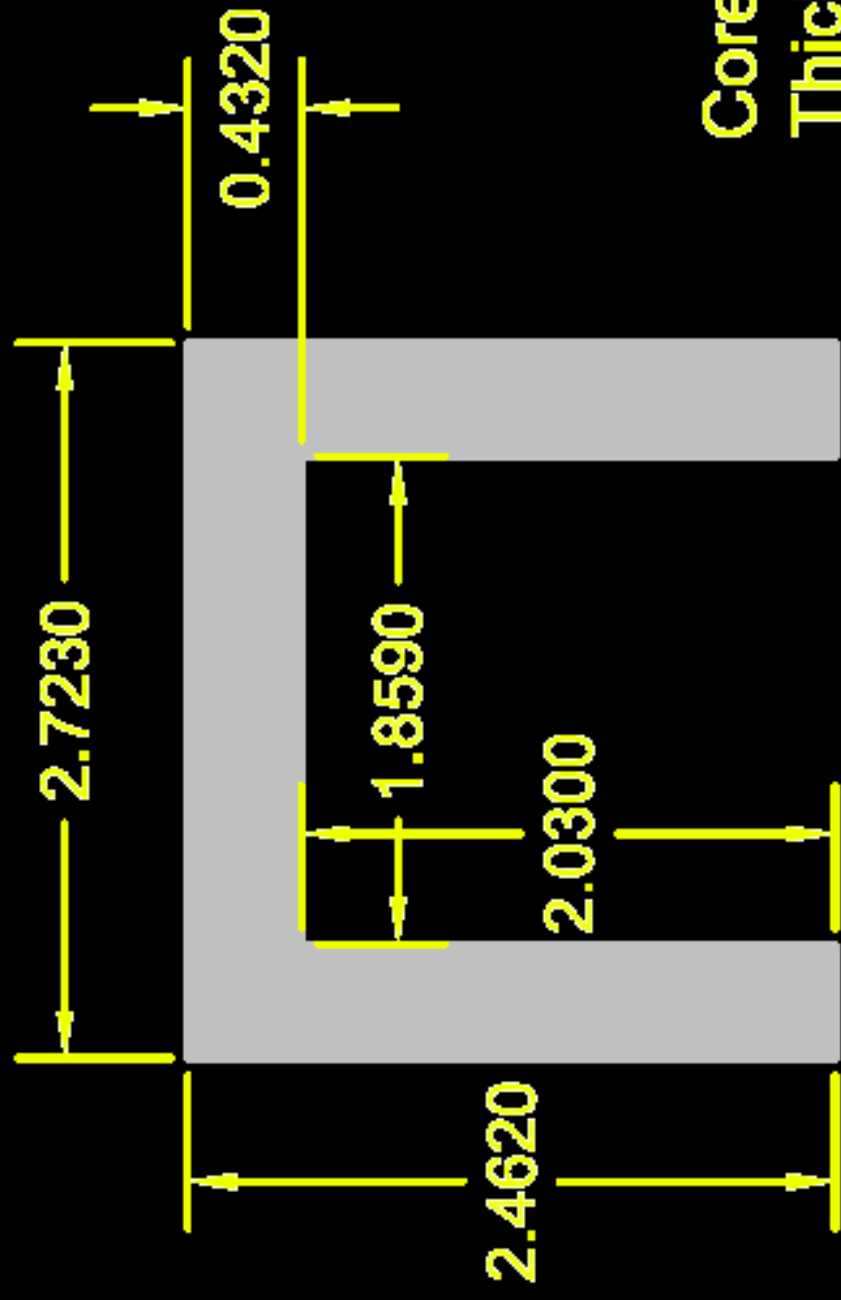

Core
Thickness :
0.105"

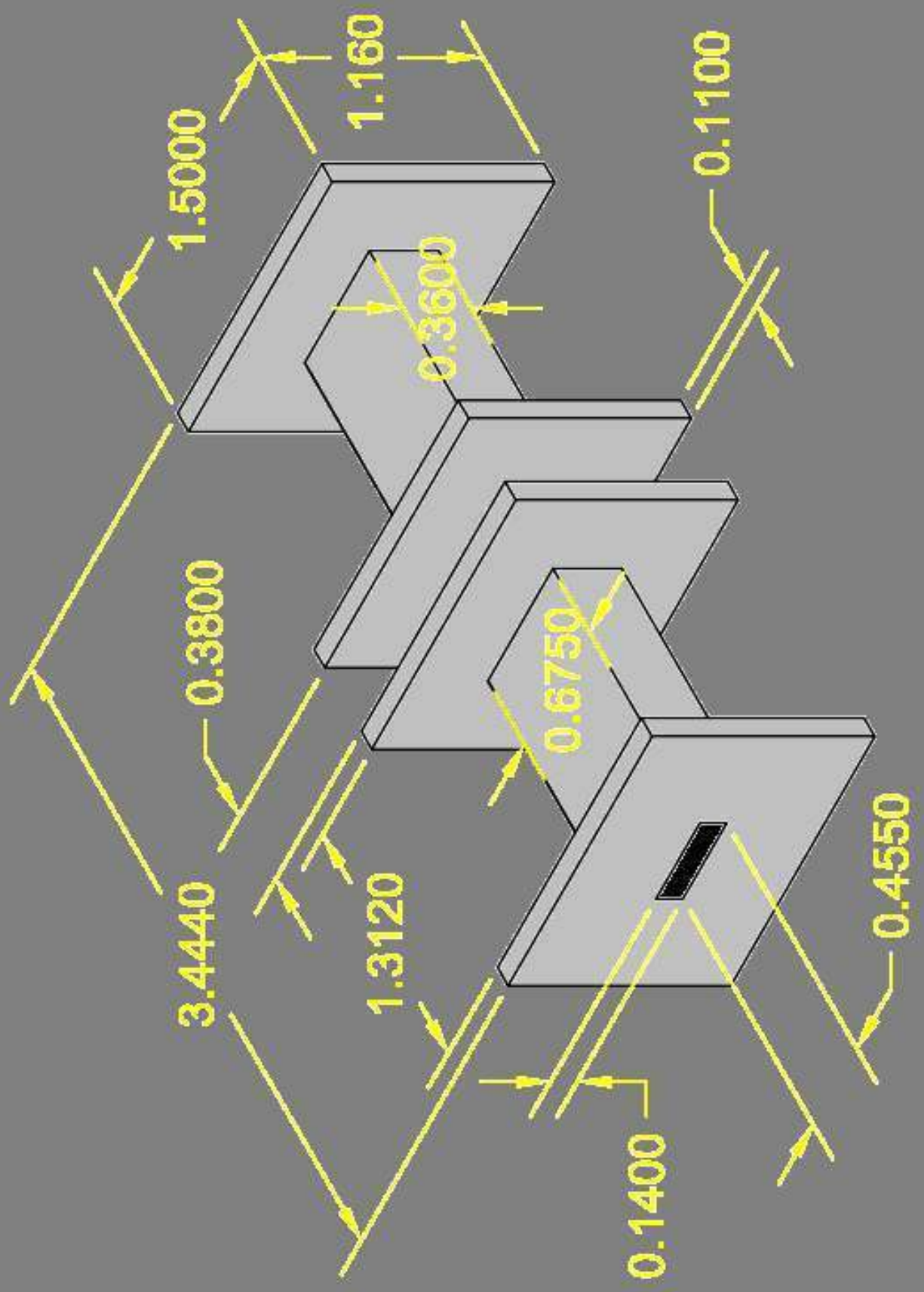

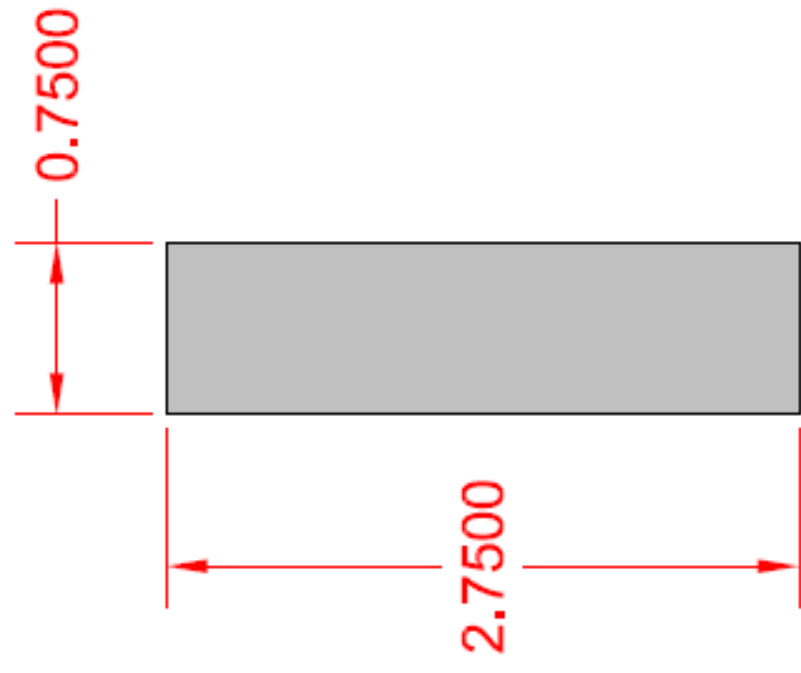

0.030" Wall
Thickness

